



555 East Lookerman St.  
Dover, Delaware 19901

McGinnis Commercial Real Estate

Phone: 302.736.2710 Fax: 302.736.2715

www.mcginnisrealty.com

COURTNEY SQUARE SHOPPING CENTER PROPERTY  
COIN LAUNDRY SPACE FOR LEASE  
431 SOUTH NEW STREET, DOVER, KENT COUNTY, DELAWARE 19904  
FILE #212146 \* MLS # N/A



<b>COIN LAUNDRY</b>		
<b>SIZE OF SPACE</b>	<b>1,500</b>	<b>sq ft +/-</b>
<b>BASE RENT</b>	<b>\$12.00</b>	<b>PSF</b>
<b>YEAR #1 BASE RENT</b>	<b>\$18,000</b>	
<b>ANNUAL INFLATOR</b>	<b>3.00%</b>	
<b>APPROX PASS-THRU CHARGES</b>	<b>\$2.97</b>	<b>PSF</b>
<b>YEAR #1 TOTAL ANNUAL RENT</b>	<b>\$14.97</b>	<b>PSF</b>
<b>YEAR #1 ANNUAL RENT</b>	<b>\$22,460</b>	
<b>YEAR #1 MONTHLY RENT</b>	<b>\$1,871.68</b>	
<b>YEAR #2 ANNUAL RENT</b>		<b>\$23,000</b>
<b>YEAR #2 MONTHLY RENT</b>		<b>\$1,916.68</b>
<b>YEAR #3 ANNUAL RENT</b>		<b>\$23,556</b>
<b>YEAR #3 MONTHLY RENT</b>		<b>\$1,963.03</b>

ALL INFORMATION SUBMITTED SUBJECT TO ERRORS AND MODIFICATIONS. ALL INFORMATION CONTAINED HEREIN OBTAINED FROM RELIABLE SOURCES BUT NOT GUARANTEED. PROSPECTIVE PURCHASERS SHOULD VERIFY ALL INFORMATION SUBMITTED. LISTING BROKERAGE REPRESENTS SELLER.  
PAGE 1 OF 5 PAGES

**COURTNEY SQUARE SHOPPING CTR**  
**429 South New Street**  
**Dover, Kent County, Delaware 19904**  
**March 30, 2012**

**Tax Map Identification** ED05-077.09-03-18.00

**Deed Reference** L - 32 - 024

**Zoning** C - 2A, Limited Central Commercial, City of Dover

<b>Land Area</b>		41,760	sq ft +/-	0.959	acre
<b>Frontage</b>	288.00	ft +/-			
<b>Depth</b>	140.00	ft +/-			
<b>Bldg Area (sq ft)</b>	12,100	sq ft +/-			
<b>Vacant Space</b>		2,000	sq ft +/-	16.53%	
<b>Coverage Ratio</b>		28.98%			
<b>Parking Spaces</b>		47			
<b>Parking Ratio</b>		1.17	per 300 sf		
<b>City Tax</b>					
<b>Assessment</b>	<b>Per Sq Ft</b>	<b>Rate</b>	<b>Tax</b>	<b>Per Sq Ft</b>	
\$1,125,100	\$92.98	\$0.338	\$3,800.59	\$0.31	PROPERTY
\$1,125,100	\$92.98	\$0.035	\$392.66	\$0.03	BID II
\$1,125,100	\$92.98	\$0.373	\$4,193.25	\$0.35	TOTAL
<b>County Tax</b>					
<b>Assessment</b>	<b>Per Sq Ft</b>	<b>Rate</b>	<b>Tax</b>	<b>Per Sq Ft</b>	
\$224,500	\$18.55	\$2.3462	\$5,267.22	\$0.44	
<b>TOTAL PROPERTY TAX</b>			\$9,460.47	\$0.78	

**PASS THRU CHARGES DECEMBER 2012**

<b>PROPERTY TAXES</b>	\$9,460.47	\$0.78
<b>PROPERTY INSURANCE</b>	\$6,471.00	\$0.53
<b>COMMON AREA MAINTENANCE</b>	\$13,891.00	\$1.15
<b>UTILITIES</b>	\$1,156.00	\$0.10
<b>REPAIRS</b>	\$5,000.00	\$0.41
<b>TOTAL BUDGET</b>	\$35,978.47	\$2.97

**ALL INFORMATION SUBMITTED SUBJECT TO ERRORS AND MODIFICATIONS. ALL INFORMATION CONTAINED HEREIN OBTAINED FROM RELIABLE SOURCES BUT NOT GUARANTEED. PROSPECTIVE PURCHASERS SHOULD VERIFY ALL INFORMATION SUBMITTED. LISTING BROKERAGE REPRESENTS SELLER.**  
**PAGE 2 OF 5 PAGES**

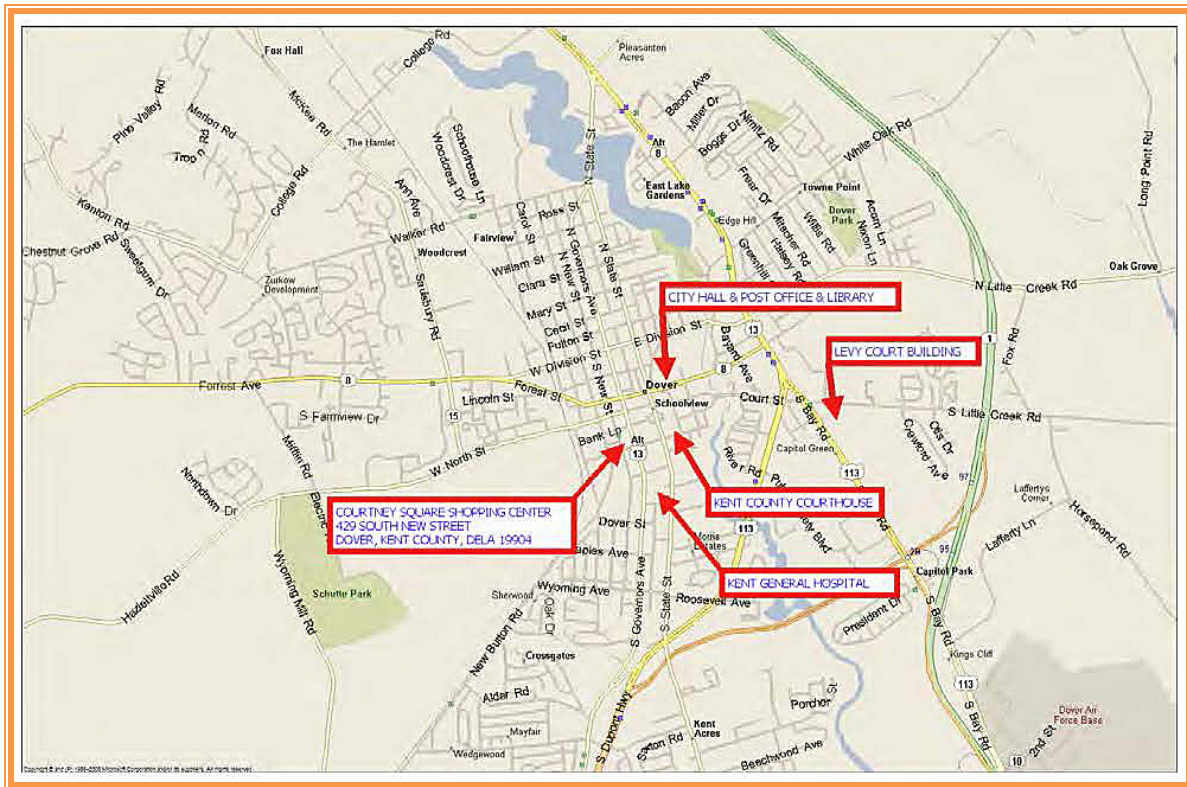

ALL INFORMATION SUBMITTED SUBJECT TO ERRORS AND MODIFICATIONS. ALL INFORMATION CONTAINED HEREIN OBTAINED FROM RELIABLE SOURCES BUT NOT GUARANTEED. PROSPECTIVE PURCHASERS SHOULD VERIFY ALL INFORMATION SUBMITTED. LISTING BROKERAGE REPRESENTS SELLER.  
PAGE 3 OF 5 PAGES

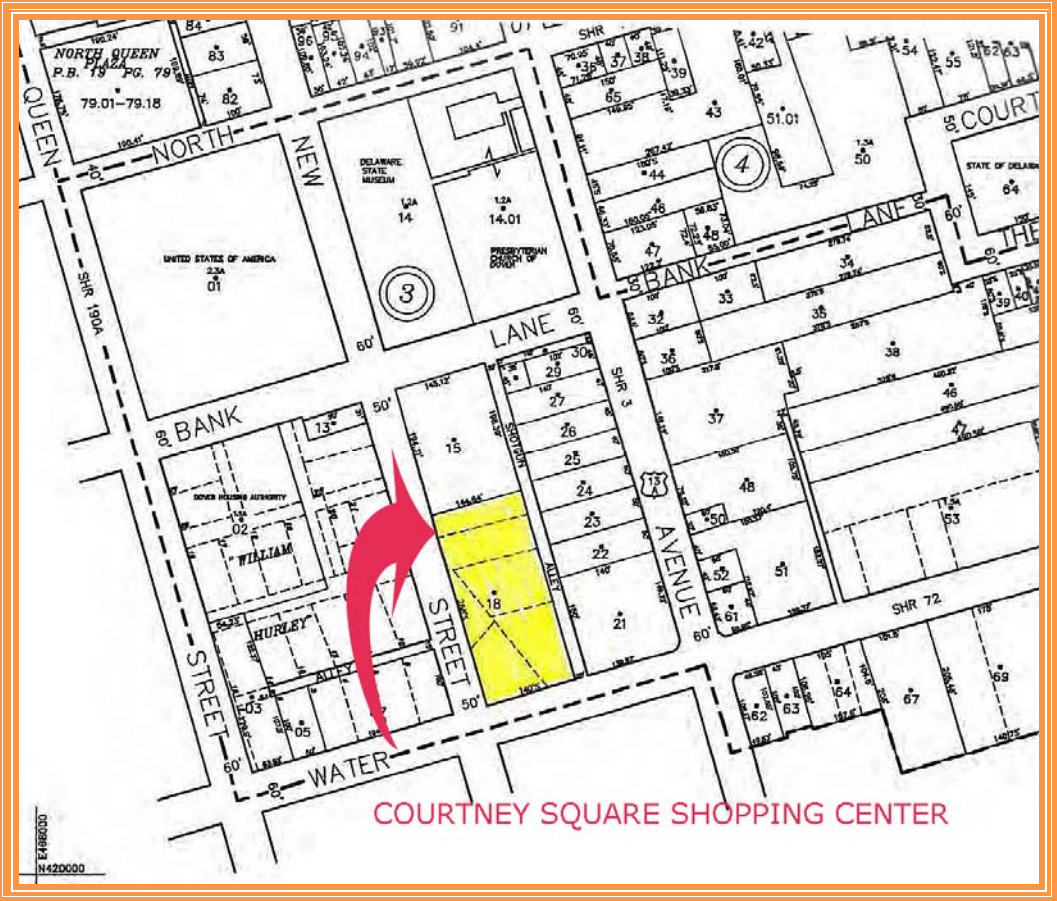
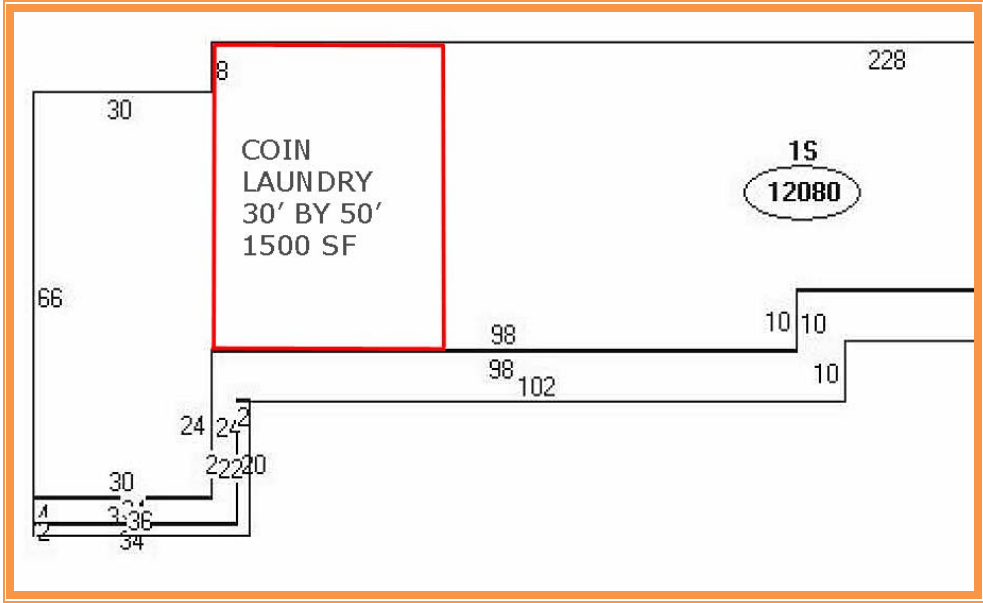

ALL INFORMATION SUBMITTED SUBJECT TO ERRORS AND MODIFICATIONS. ALL INFORMATION CONTAINED HEREIN OBTAINED FROM RELIABLE SOURCES BUT NOT GUARANTEED. PROSPECTIVE PURCHASERS SHOULD VERIFY ALL INFORMATION SUBMITTED. LISTING BROKERAGE REPRESENTS SELLER. PAGE 4 OF 5 PAGES

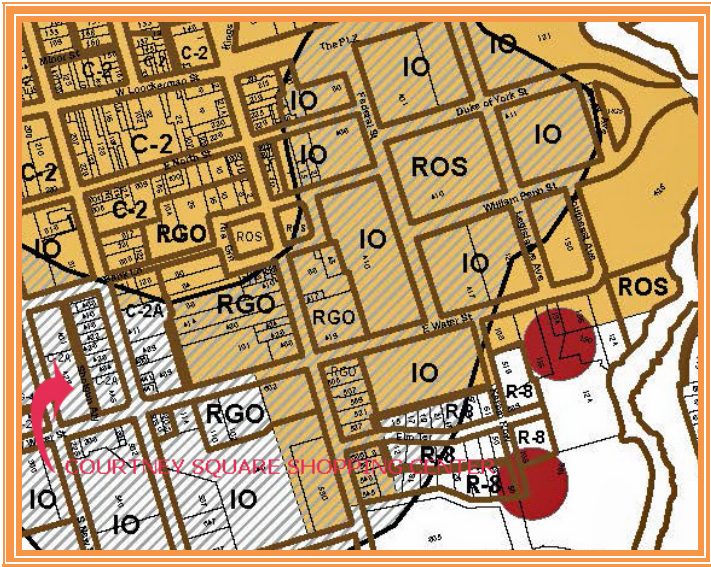

ALL INFORMATION SUBMITTED SUBJECT TO ERRORS AND MODIFICATIONS. ALL INFORMATION CONTAINED HEREIN OBTAINED FROM RELIABLE SOURCES BUT NOT GUARANTEED. PROSPECTIVE PURCHASERS SHOULD VERIFY ALL INFORMATION SUBMITTED. LISTING BROKERAGE REPRESENTS SELLER.  
PAGE 5 OF 5 PAGES