



DOVER PRODUCTS PROPERTY

5200 DENNEYS ROAD, DOVER, KENT COUNTY, DELAWARE 19904

OFFICE FILE# 213186 MLS# 6245568

FOR SALE

16 ACRE INDUSTRIAL / INVESTMENT PROPERTY



SALE PRICE \$ 1,100,000 * \$ 69,000 +/- PER ACRE

16+/- ACRES ZONED INDUSTRIAL WITH ROOM FOR EXPANSION

11,245 SQUARE FEET OF BUILDING SPACE

USES INCLUDE WAREHOUSE OR LIGHT MANUFACTURING

BUILDINGS RANGE IN SIZE FROM 1,200-5,625 SQUARE FEET

LOCATED LESS THAN 5 MILES FROM US ROUTE 13 AND ROUTE 1

ALL INFORMATION SUBMITTED SUBJECT TO ERRORS AND MODIFICATIONS. ALL INFORMATION CONTAINED HEREIN OBTAINED FROM RELIABLE SOURCES BUT NOT GUARANTEED. PROSPECTIVE PURCHASERS SHOULD VERIFY ALL INFORMATION SUBMITTED. LISTING BROKERAGE REPRESENTS SELLER.
PAGE 1 OF 3 PAGES

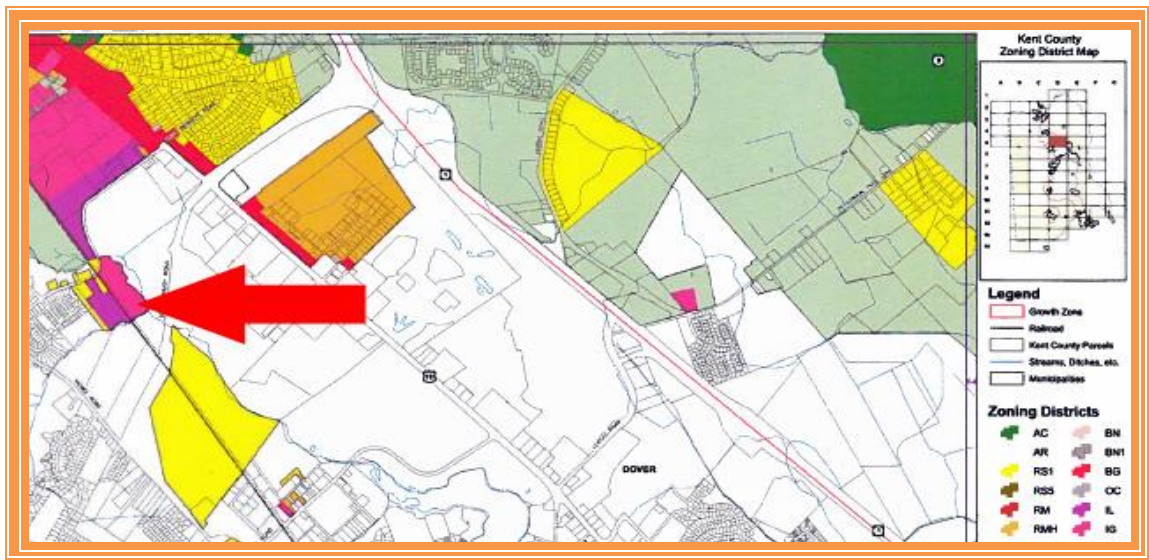
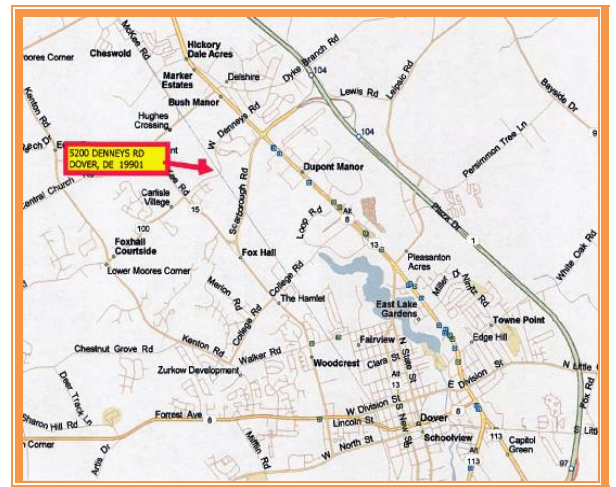

ALL INFORMATION SUBMITTED SUBJECT TO ERRORS AND MODIFICATIONS. ALL INFORMATION CONTAINED HEREIN OBTAINED FROM RELIABLE SOURCES BUT NOT GUARANTEED. PROSPECTIVE PURCHASERS SHOULD VERIFY ALL INFORMATION SUBMITTED. LISTING BROKERAGE REPRESENTS SELLER.
PAGE 2 OF 3 PAGES

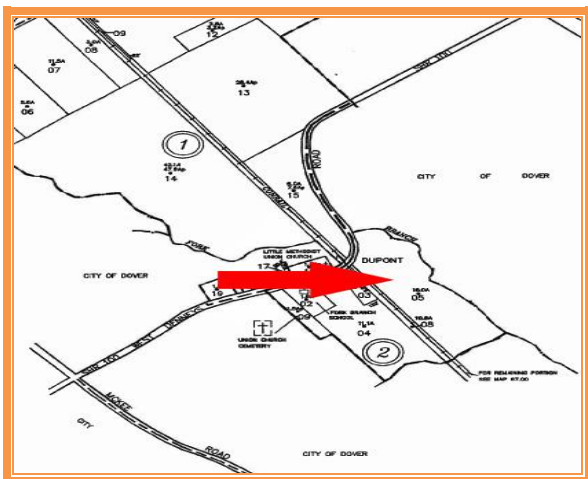

DOVER PRODUCTS PROPERTY
5200 DENNEYS ROAD
DOVER, KENT COUNTY, DE
July 8, 2013

Tax Map Identification	ED-00-05700-02-0500
Deed Reference	K 025 489
Zoning	I-G Kent County
Land Area	16 +/- Acres
Total Bldg Area (sq ft)	11,245 +/-
Land Assessed Value	\$33,600
Building Assessed Value	\$72,400.00
Total Property Assessment	\$115,700.00
TOTAL PROPERTY TAX 2012	\$2,752.73

FOR ADDITIONAL INFORMATION CONTACT:

CHUCK SPIEGELMAN, ASSOCIATE BROKER
MCGINNIS COMMERCIAL REAL ESTATE

OFFICE: 302-736-2710

FAX: 302-736-2715

MOBILE: 302-632-0859

EMAIL: cs@mcginnisrealty.com

ALL INFORMATION SUBMITTED SUBJECT TO ERRORS AND MODIFICATIONS. ALL INFORMATION CONTAINED HEREIN OBTAINED FROM RELIABLE SOURCES BUT NOT GUARANTEED. PROSPECTIVE PURCHASERS SHOULD VERIFY ALL INFORMATION SUBMITTED. LISTING BROKERAGE REPRESENTS SELLER.
PAGE 3 OF 3 PAGES