



555 East Lookerman St.  
Dover, Delaware 19901

Phone: 302.736.2710 Fax: 302.736.2715

[www.mcginnisrealty.com](http://www.mcginnisrealty.com)

DELAWARE FEDERATION OF REPUBLICAN WOMEN PROPERTY  
116-120 EAST WATER STREET, DOVER, KENT COUNTY, DELAWARE 19901  
FILE #211134 \* MLS # N/A



<b>SIZE OF SPACE</b>	<b>3,128</b>	<b>sq ft +/-</b>
<b>BASE RENT</b>	<b>\$17.00</b>	<b>PSF</b>
<b>YEAR #1 BASE RENT</b>	<b>\$53,176</b>	
<b>ANNUAL INFLATOR</b>	<b>3.00%</b>	
<b>APPROX PASS-THRU CHARGES</b>	<b>\$1.40</b>	<b>PSF</b>
<b>YEAR #1 TOTAL ANNUAL RENT</b>	<b>\$18.40</b>	<b>PSF</b>
<b>YEAR #1 ANNUAL RENT</b>	<b>\$57,544</b>	
<b>YEAR #1 MONTHLY RENT</b>	<b>\$4,795.31</b>	

ALL INFORMATION SUBMITTED SUBJECT TO ERRORS AND MODIFICATIONS. ALL INFORMATION  
CONTAINED HEREIN OBTAINED FROM RELIABLE SOURCES BUT NOT GUARANTEED. PROSPECTIVE  
PURCHASERS SHOULD VERIFY ALL INFORMATION SUBMITTED. LISTING BROKERAGE REPRESENTS SELLER.  
PAGE 1 OF 5 PAGES

**Tax Map Identification** ED05-077.09-05-39.00

**Deed Reference** Z - 22 - 562

**Zoning** IO, Institutional Office, City of Dover

<b>Land Area</b>		27,469	sq ft +/-	0.631	acre
<b>Frontage</b>	91.50	ft +/-			
<b>Depth</b>	300.99	ft +/-			
<b>Bldg Area (sq ft)</b>	3,128	sq ft +/-			
<b>Coverage Ratio</b>		11.39%			
<b>Parking Spaces</b>		15			
<b>Parking Ratio</b>		2.40	per 500 sf		

<b>City Tax Assessment</b>	<b>Per Sq Ft</b>	<b>Rate</b>	<b>Tax</b>	<b>Per Sq Ft</b>	
\$615,100	\$196.64	\$0.338	\$2,077.81	\$0.66	PROPERTY
\$615,100	\$196.64	\$0.035	\$214.67	\$0.07	BID II
\$615,100	\$196.64	\$0.373	\$2,292.48	\$0.73	TOTAL

<b>County Tax Assessment</b>	<b>Per Sq Ft</b>	<b>Rate</b>	<b>Tax</b>	<b>Per Sq Ft</b>	
\$176,700	\$56.49	\$2.2671	\$4,005.97	\$1.28	

<b>TOTAL PROPERTY TAX</b>			\$6,298.44	\$1.22	
---------------------------	--	--	------------	--------	--

<b>HAZARD INSURANCE</b>			\$929.00	\$0.18	
-------------------------	--	--	----------	--------	--

**PASS THRU CHARGES AUGUST 2011**

<b>PROPERTY TAXES</b>	\$1.22				
<b>PROPERTY INSURANCE</b>	\$0.18				
<b>TOTAL</b>	\$1.40				
<b>PASS THRU EXPENSES</b>	<b>\$1.40</b>	<b>3,128</b>	<b>\$4,367.74</b>	<b>\$363.98</b>	

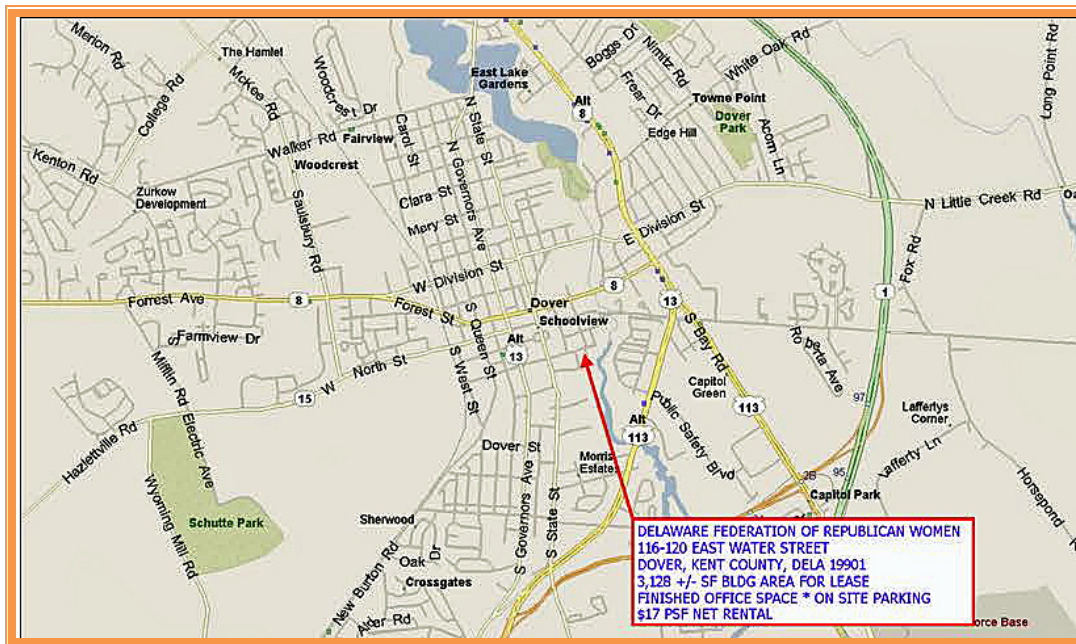

ALL INFORMATION SUBMITTED SUBJECT TO ERRORS AND MODIFICATIONS. ALL INFORMATION CONTAINED HEREIN OBTAINED FROM RELIABLE SOURCES BUT NOT GUARANTEED. PROSPECTIVE PURCHASERS SHOULD VERIFY ALL INFORMATION SUBMITTED. LISTING BROKERAGE REPRESENTS SELLER.  
 PAGE 3 OF 5 PAGES



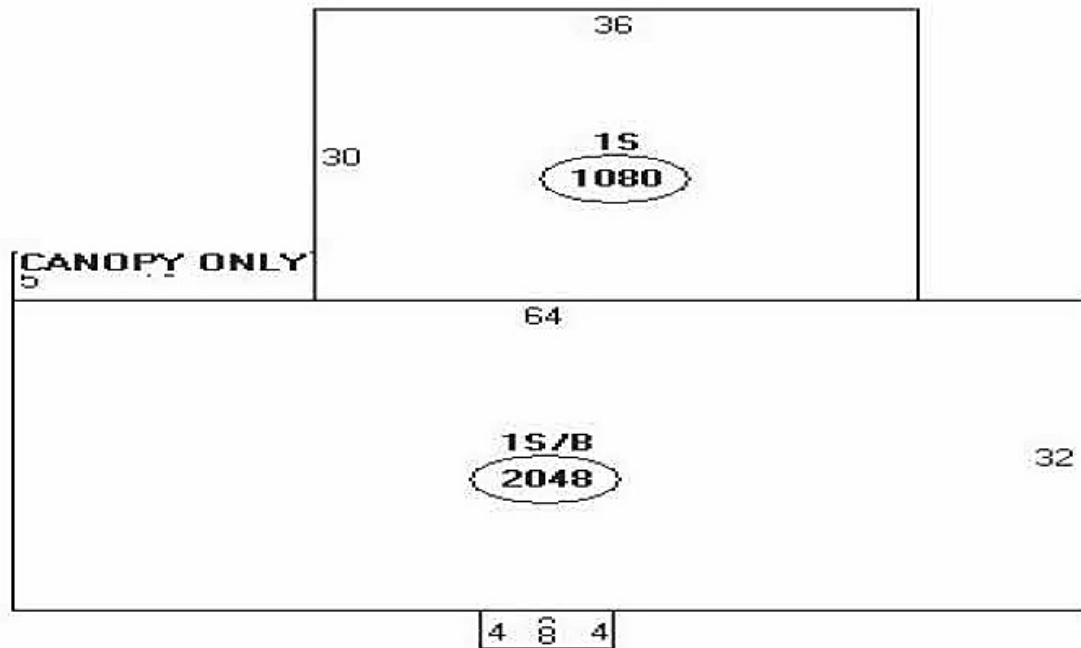

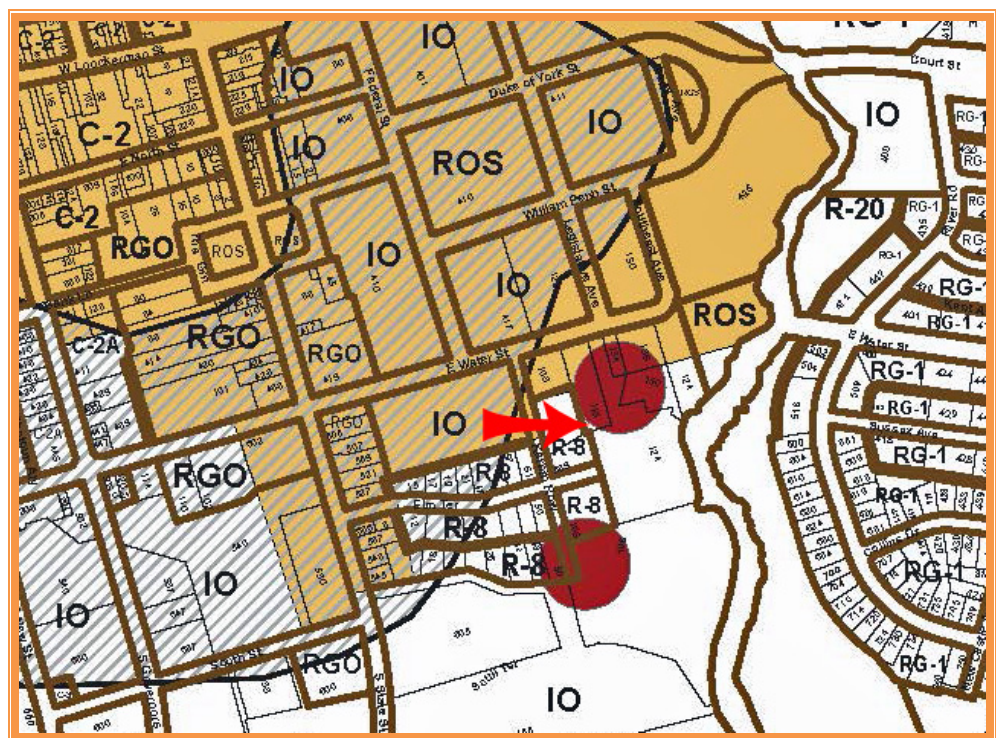
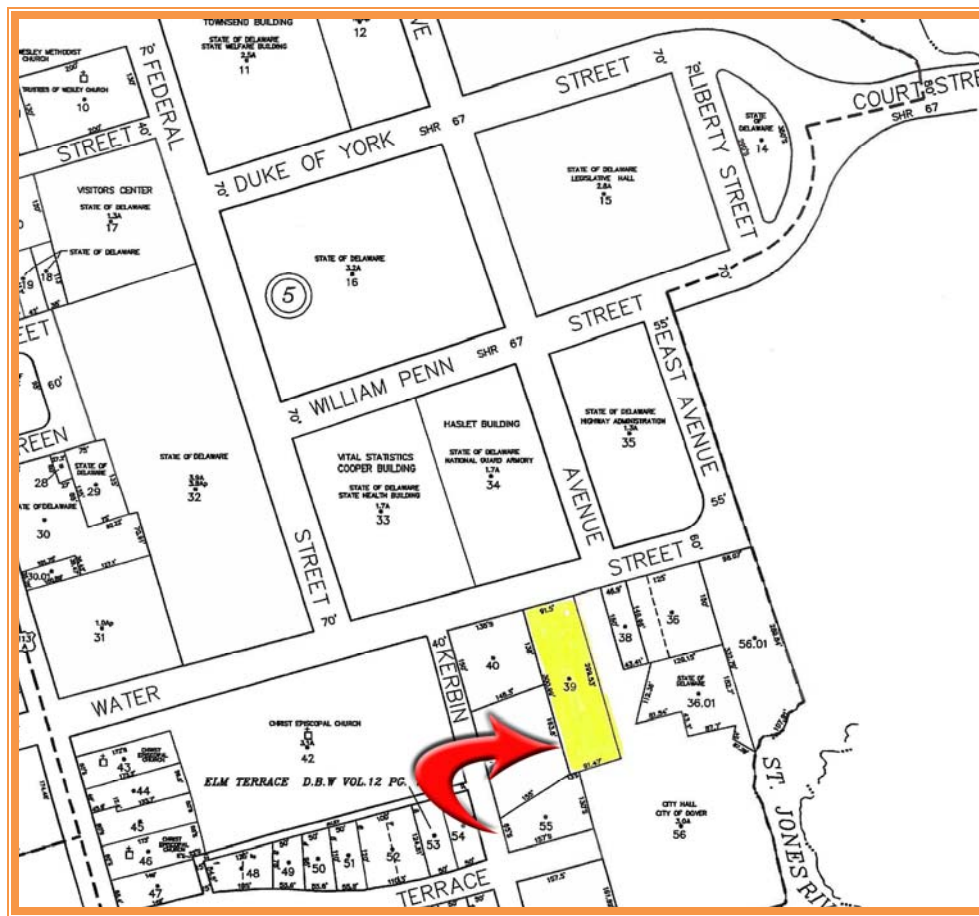

ALL INFORMATION SUBMITTED SUBJECT TO ERRORS AND MODIFICATIONS. ALL INFORMATION CONTAINED HEREIN OBTAINED FROM RELIABLE SOURCES BUT NOT GUARANTEED. PROSPECTIVE PURCHASERS SHOULD VERIFY ALL INFORMATION SUBMITTED. LISTING BROKERAGE REPRESENTS SELLER.

PAGE 5 OF 5 PAGES