

WINDSOR BUILDING Property
144-146 GOVERNORS AVENUE, DOVER, KENT COUNTY, DELAWARE 19901

OFFICE FILE # 213175 * MLS # 6798930

FOR SALE * PRICE REDUCED



16,746 SQUARE FOOT MULTI-USE /OFFICE BUILDING FOR SALE

SALE PRICE \$1,100,000 * \$65.69 PER SQUARE FOOT

**CONVENIENT DOWNTOWN LOCATION
CURRENTLY OWNER OCCUPIED (2ND FLOOR)
FIRST FLOOR RETAIL * FULLY LEASED
FULL BASEMENT FOR ADDITIONAL STORAGE
HISTORIC BUILDING WITH EXTENSIVE 2nd FLOOR FIT OUT.
PERMIT PARKING AND PUBLIC PARKING NEAR-BY**

**ALL INFORMATION SUBMITTED SUBJECT TO ERRORS AND MODIFICATIONS. ALL INFORMATION
CONTAINED HEREIN OBTAINED FROM RELIABLE SOURCES BUT NOT GUARANTEED. PROSPECTIVE
PURCHASERS SHOULD VERIFY ALL INFORMATION SUBMITTED. LISTING BROKERAGE REPRESENTS SELLER.
PAGE 1 OF 5 PAGES**

WINDSOR BUILDING PROPERTY
144-146 GOVERNORS AVE
Dover, Kent County, Delaware 19901
May 15, 2016

Tax Map Identification	ED05-077.09-01-4600 & 4700		
Deed Reference	D4218 0273		
Zoning	C-2 CITY OF DOVER		
Census Tract	414		
Flood Map	10001C0167H	Dated 5/5/03	Zone X
Land Area	16,746 Sq Ft		
Total Bldg Area (sq ft)	16,746		
Available Office Space	100% leased		
City Tax	\$2,726.38		
County Tax	\$5,974.26		
TOTAL BUILDING PROPERTY TAX	\$8,700.64		

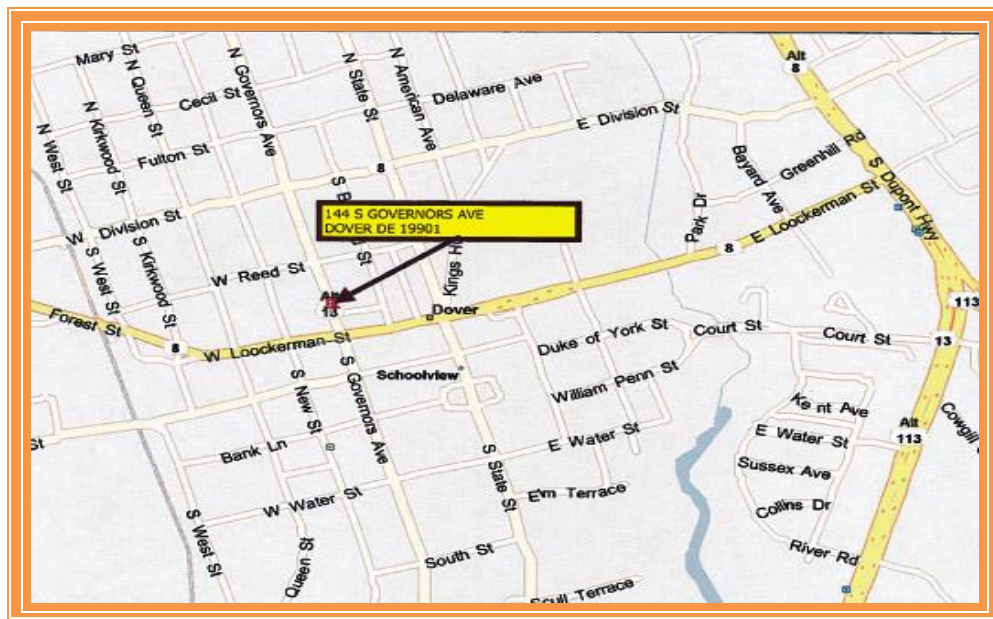

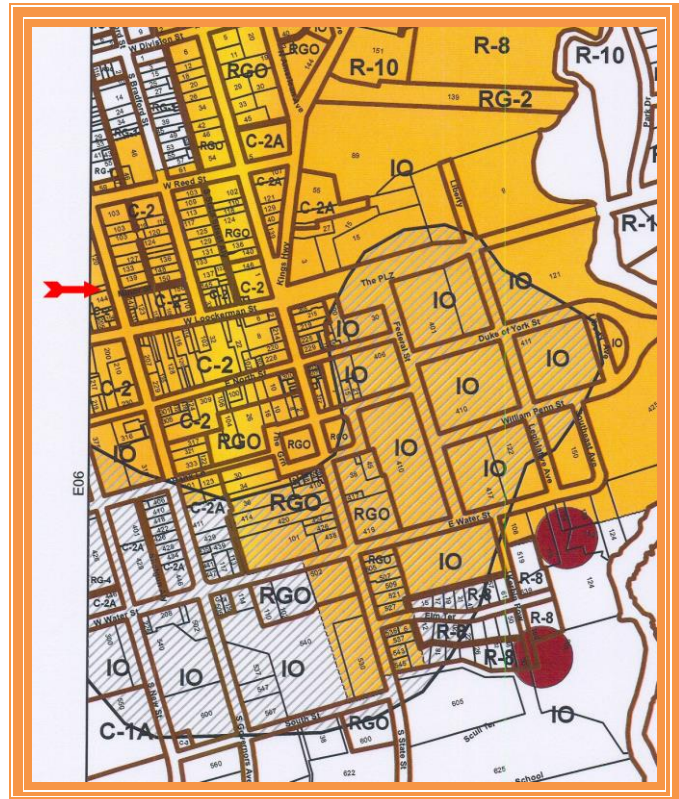
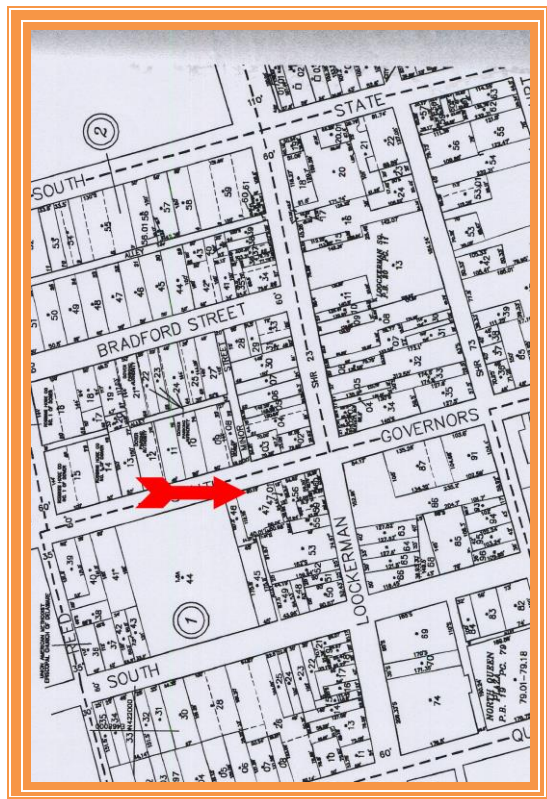
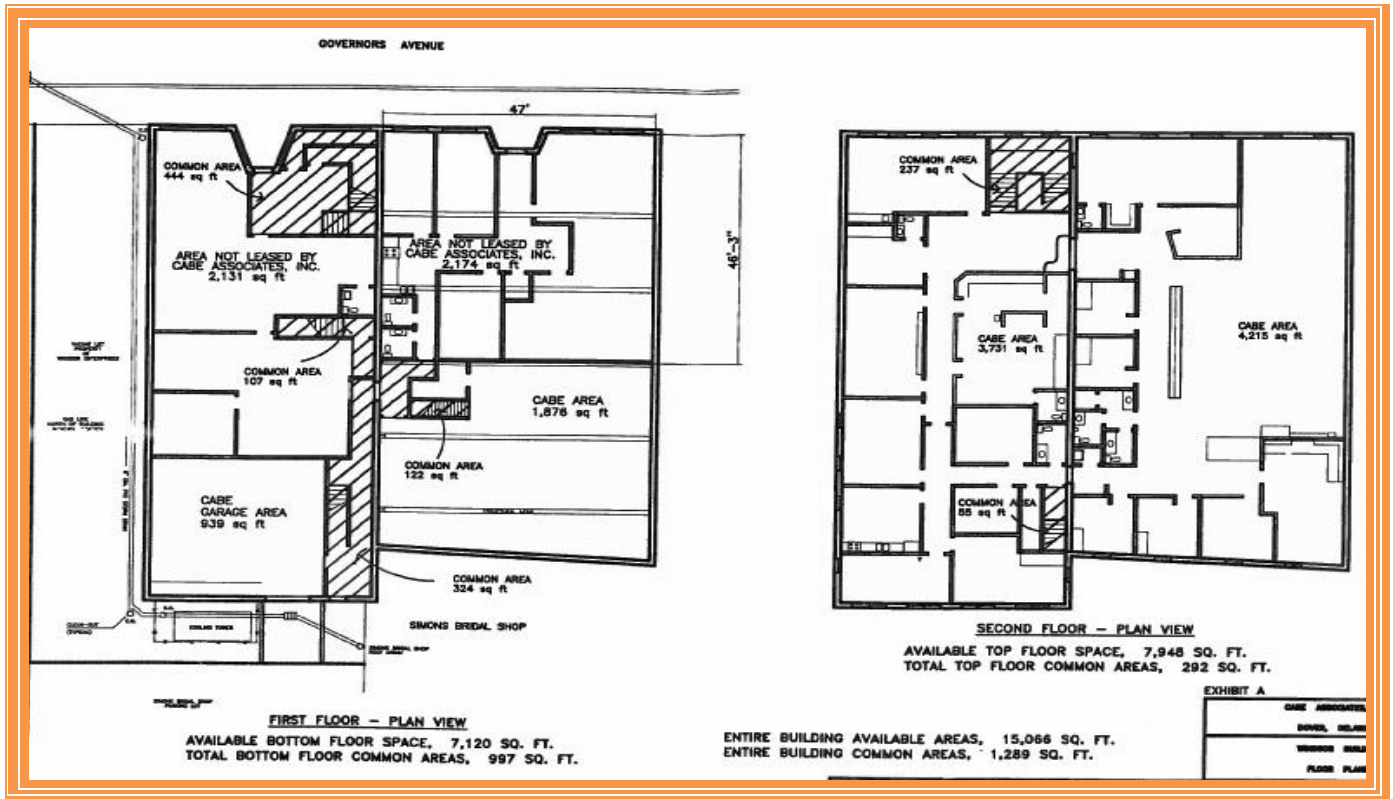



ALL INFORMATION SUBMITTED SUBJECT TO ERRORS AND MODIFICATIONS. ALL INFORMATION CONTAINED HEREIN OBTAINED FROM RELIABLE SOURCES BUT NOT GUARANTEED. PROSPECTIVE PURCHASERS SHOULD VERIFY ALL INFORMATION SUBMITTED. LISTING BROKERAGE REPRESENTS SELLER.
PAGE 4 OF 5 PAGES



For Additional Information Contact:

Chuck Spiegelman, Associate Broker
McGinnis Commercial Real Estate Company

Office: 302-736-2710

Fax: 302-736-2715

Mobile: 302-632-0859

E Mail: cs@mcginnisrealty.com

**ALL INFORMATION SUBMITTED SUBJECT TO ERRORS AND MODIFICATIONS. ALL INFORMATION
CONTAINED HEREIN OBTAINED FROM RELIABLE SOURCES BUT NOT GUARANTEED. PROSPECTIVE
PURCHASERS SHOULD VERIFY ALL INFORMATION SUBMITTED. LISTING BROKERAGE REPRESENTS SELLER.
PAGE 5 OF 5 PAGES**