

SMYRNA MEDICAL SUITE PROPERTY
103 SOUTH DUPONT BLVD, SUITE 1, SMYRNA, KENT COUNTY, DELAWARE 19977

OFFICE FILE# 216259

FOR LEASE
2,000 SQUARE FOOT MEDICAL OFFICE SUITE PROPERTY



LEASE PRICE \$ 3,000 PER MONTH * \$ 18.00 PER SQUARE FOOT

JOIN ATLANTIC APOTHECARY

MEDICAL SUITE WITH HIGHWAY VISIBILITY

CONVENIENT HIGHWAY (Route 13) LOCATION

MANY FIT-OUT OPTIONS/BUILD TO SUIT

POSSIBLE USES INCLUDE LAB, GP, DENTAL, PROFESSIONAL OFFICE

SMYRNA MEDICAL SUITE
103 SOUTH DUPONT BLVD, SUITE 1
SMYRNA, KENT COUNTY, DE 19977
June 24, 2016

Tax Map Identification 1-17-01018-02-0100

Deed Reference D7723 148

Zoning H-C Highway Commercial
Town of Smyrna

Rentable square footage of Suite 2,000 +/-
Usable square footage of Suite 1,666 +/-

Total Bldg Area (sq ft) 10,000 +/-

Total Building taxes (2015) \$3,640

Taxes for Suite 1 (Smyrna Medical Suite) \$728

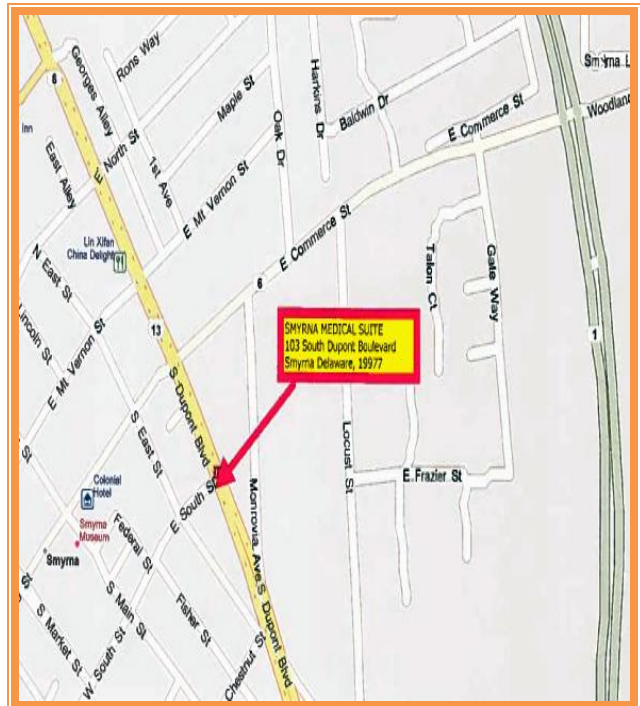
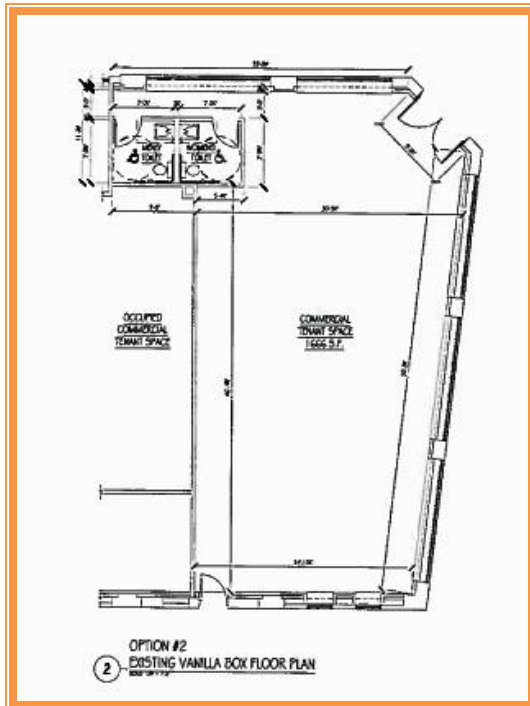



VIEW LOOKING NORTH



VIEW OF SUITE ENTRANCE LOOKING SOUTH

ALL INFORMATION SUBMITTED SUBJECT TO ERRORS AND MODIFICATIONS. ALL INFORMATION CONTAINED HEREIN OBTAINED FROM RELIABLE SOURCES BUT NOT GUARANTEED. PROSPECTIVE PURCHASERS SHOULD VERIFY ALL INFORMATION SUBMITTED. LISTING BROKERAGE REPRESENTS SELLER.
PAGE 3 OF 4 PAGES



FOR ADDITIONAL INFORMATION CONTACT:

**CHUCK SPIEGELMAN, ASSOCIATE BROKER
MCGINNIS COMMERCIAL REAL ESTATE**

OFFICE: 302-736-2710

FAX: 302-736-2715

MOBILE: 302-632-0859

EMAIL: cs@mcginnisrealty.com